



APPLICATIONS

- Continuity restoration of metal armours and shields

KEY FEATURES

- Safe electrical contact thanks to the spring closing force
- Installation without soldering

FEATURES

- Stainless steel spring

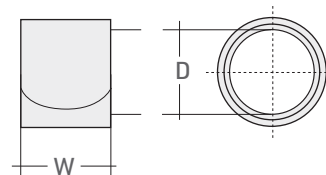

width W	ref.	item	wrap diameter min-max (mm)	length (mm)	diameter D (mm)	min./mult. ord. qty (pcs)
13 mm	RS034A	RS034-A	12 – 20	280	10	1
	RS034K	RS034-K	12 – 20	400	10	1
	RS034B	RS034-B	17 – 28	400	14	1
	RS034C	RS034-C	25 – 40	570	20	1
	RS034D	RS034-D	36 – 60	850	30	1
25 mm	RS034E	RS034-E	17 – 29	570	14	1
	RS034N	RS034-N	25 – 34	650	19	1
	RS034F	RS034-F	30 – 39	700	22	1
	RS034M	RS034-M	33 – 45	850	25	1
	RS034G	RS034-G	40 – 60	950	30	1
30 mm	RS034H	RS034-H	50 – 75	1100	38	1
	RS034I	RS034-I	50 – 75	1350	38	1
	RS034L	RS034-L	57 – 85	1350	45	1
	RS034O	RS034-O	85 – 110	1500	70	1





APPLICATIONS

- Continuity restoration of metal armours and shields

KIT CONTENTS

- no. 2 steel constant force contact springs
- Tinned copper braid

Rated voltage U_0/U (kV)	voltage class U_m	ref.	item	diameter of application (mm)	cores		min. / mult. ord. qty (pcs)
							
					conductor cross-section* (mm ²)		
8.7/15	17.5 kV	ARMJT2540	ARM-JTMT 25/40	25 – 40	25 – 150	–	1
		ARMJT4060	ARM-JTMT 40/60	40 – 60	150 – 400	16 – 50	1
		ARMJT5075	ARM-JTMT 50/75	50 – 75	500 – 630	35 – 120	1
		ARMJT5785	ARM-JTMT 57/85	57 – 85	–	95 – 240	1
		ARMJT85110	ARM-JTMT 85/110	85 – 110	–	300	1
12/20	24 kV	ARMJT2540	ARM-JTMT 25/40	25 – 40	25 – 95	–	1
		ARMJT4060	ARM-JTMT 40/60	40 – 60	120 – 300	–	1
		ARMJT5075	ARM-JTMT 50/75	50 – 75	400 – 630	35 – 95	1
		ARMJT5785	ARM-JTMT 57/85	57 – 85	–	50 – 185	1
		ARMJT85110	ARM-JTMT 85/110	85 – 110	–	240 – 300	1
18/30	36 kV	ARMJT2540	ARM-JTMT 25/40	25 – 40	35 – 95	–	1
		ARMJT4060	ARM-JTMT 40/60	40 – 60	120 – 400	–	1
		ARMJT5075	ARM-JTMT 50/75	50 – 75	400 – 630	–	1
		ARMJT5785	ARM-JTMT 57/85	57 – 85	–	35 – 95	1
		ARMJT85110	ARM-JTMT 85/110	85 – 110	–	120 – 300	1

* Allowed indicative conductor cross-sections referred to single-core cables type RG7H1ANR and three-core cables type RG7H1OZR